

PixLite Pro™ Datasheet

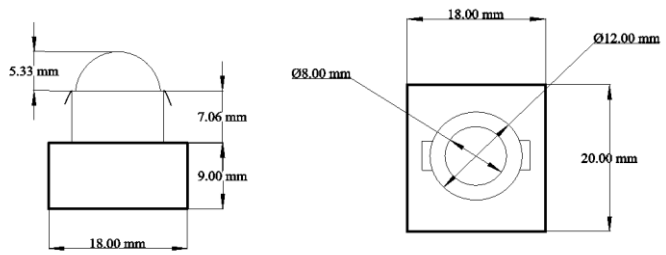

Specifications:

| | |
|---------------------------|--------------------------------|
| Product Name: | PixLite Pro™ |
| Model: | PIXPRO |
| Color: | RGB |
| LED Viewing Angle: | 180 degrees |
| Rated Voltage: | DC5V |
| Rated Power: | 16W |
| Pixel IC | MY9231 (16 bit) |
| Wire Gauge | 18AWG |
| Weight | 1.15Kg |
| Pixel Spacing | 100mm |
| String Length | 10m |
| Leading Cable Length | 2m |
| Mounting LED Diameter: | 12mm |
| Mounting Plate Thickness: | <2.0mm |
| Protection Grade: | IP68 (with high UV durability) |
| Expected Lifespan: | 50,000H |
| Product Warranty: | 2 Years |